

# TECHNICAL DATASHEET



## REDUCED TEE 90°

03 Update - 04/2024

### TECHNICAL DATA

Article No	001 115 0042 0411
d1 (mm)	400
d2 (mm)	110
L (mm)	615
le1 (mm)	189
le2 (mm)	87
Z (mm)	327
s1 (mm)	23,7
s2 (mm)	6,6
Weight (Kg)	18,390
Box Quantity (pcs)	1
Box Dimension (pcs)	68x68x45,5

### IDENTIFICATION OF PRODUCT

D(mm)	400-110
SDR	17
RAW METARIAL	PE 100
PRESSURE CLASS	10 Bar Water 6 Bar Gas
TRADEMARK	NTG
EXECUTION	Injection Moulded
STANDARD	EN 12201-3 EN 1555-3 AS /NZS 4129

### INJECTION MOULDED

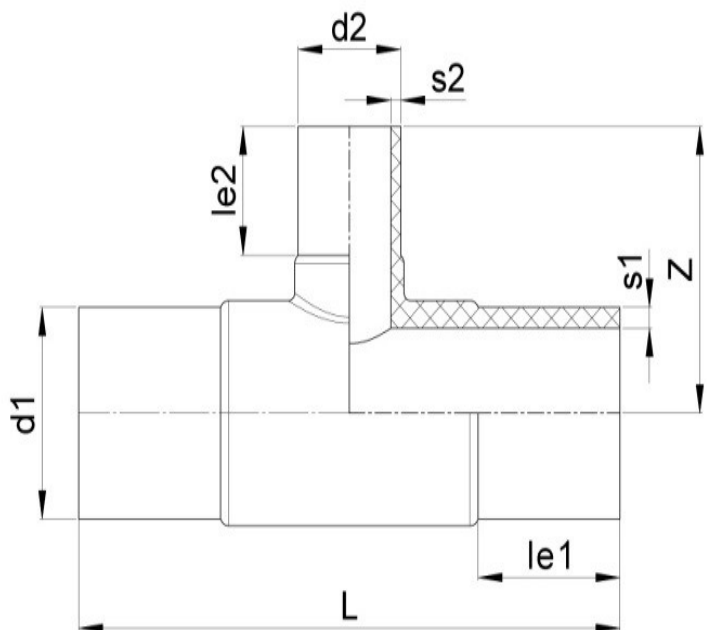

### SPECIFICATION

Long Spigot

Tolerance on diameters and thickness according to the standards. The other dimensions are specialized. Tolerance  $\pm 5\%$ . NTG PLASTIK reserves all the right to change any information without giving prior notice. The production, distribution and utilization of this document without explicit authorization is prohibited.